

INSTALLATION AND SERVICE MANUAL

LIGMAN
LIGHTING USA

For Installation of Tango wall surface luminaire LED
Model. UTA-31862, UTA-31863, UTA-31872, UTA-31873, UTA-31883, UTA-31893

Product drawing (dimensions) SUITABLE FOR WET LOCATIONS

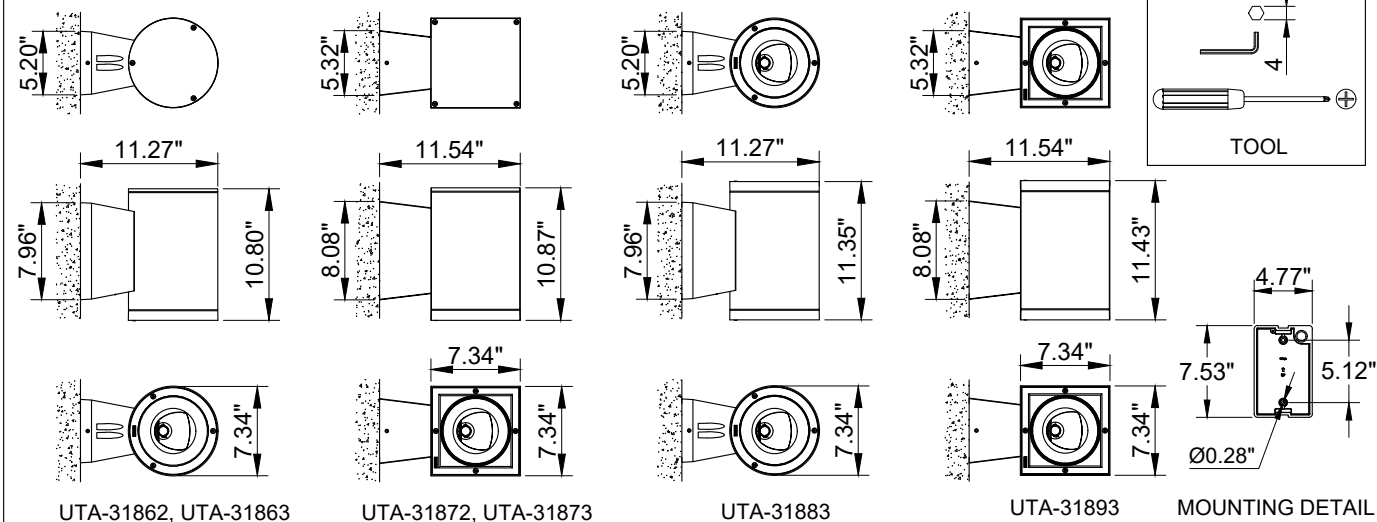

NOTE

Mounts over
a 3\"Octagonal
Junction box.

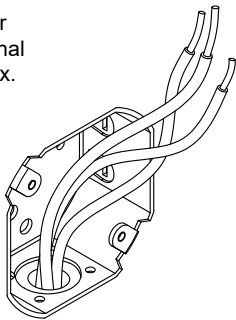

1

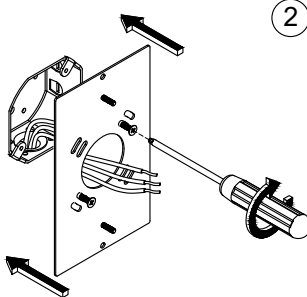

2

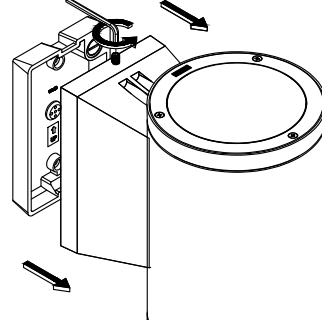

3

Using the nylon washers
and the 7mm. nut driver
secure the back
plate to the wall

UP

Ensure watertight seal using UL
approved silicone based sealant.

4

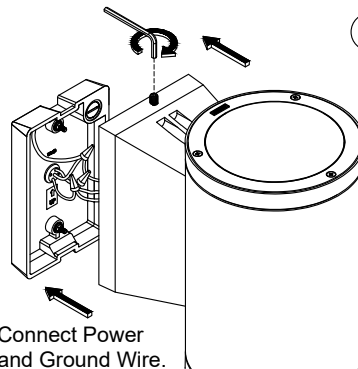

Connect Power
and Ground Wire.

5

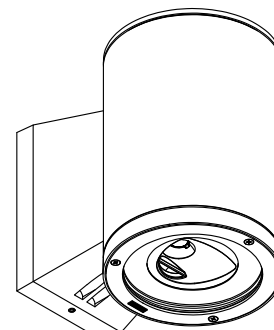

6

Notice to installer :

- 1.WIRING INSTRUCTIONS** Warning : RISK OF FIRE AND ELECTRICAL SHOCK. : FIXTURE MUST BE INSTALLED BY A QUALIFIED ELECTRICIAN ONLY>FIXTURE IS INTENDED FOR INSTALLATION IN ACCORDANCE WITH THE NATIONAL ELECTRICAL CODE, LOCAL AND FEDERAL CODE SPECIFICATIONS. DISCONNECT POWER BEFORE SERVICING.
- 2.This fixture has a VOLTAGE SPECIFIC BALLAST**,Check that the supply voltage is the same as the installed ballast voltage.

Ligman Lighting USA

7144 NE Progress Court, Hillsboro
Oregon, 97124, USA
Tel : 503 645 0500 | Fax : 503 645 8100

www.ligmanlightingusa.com

UTA-31862 04/03/24 REV.0
1/1

FM-TS-13-1/13-05-2563/Rev.6